

KEY PLAN  
(Not To Scale)

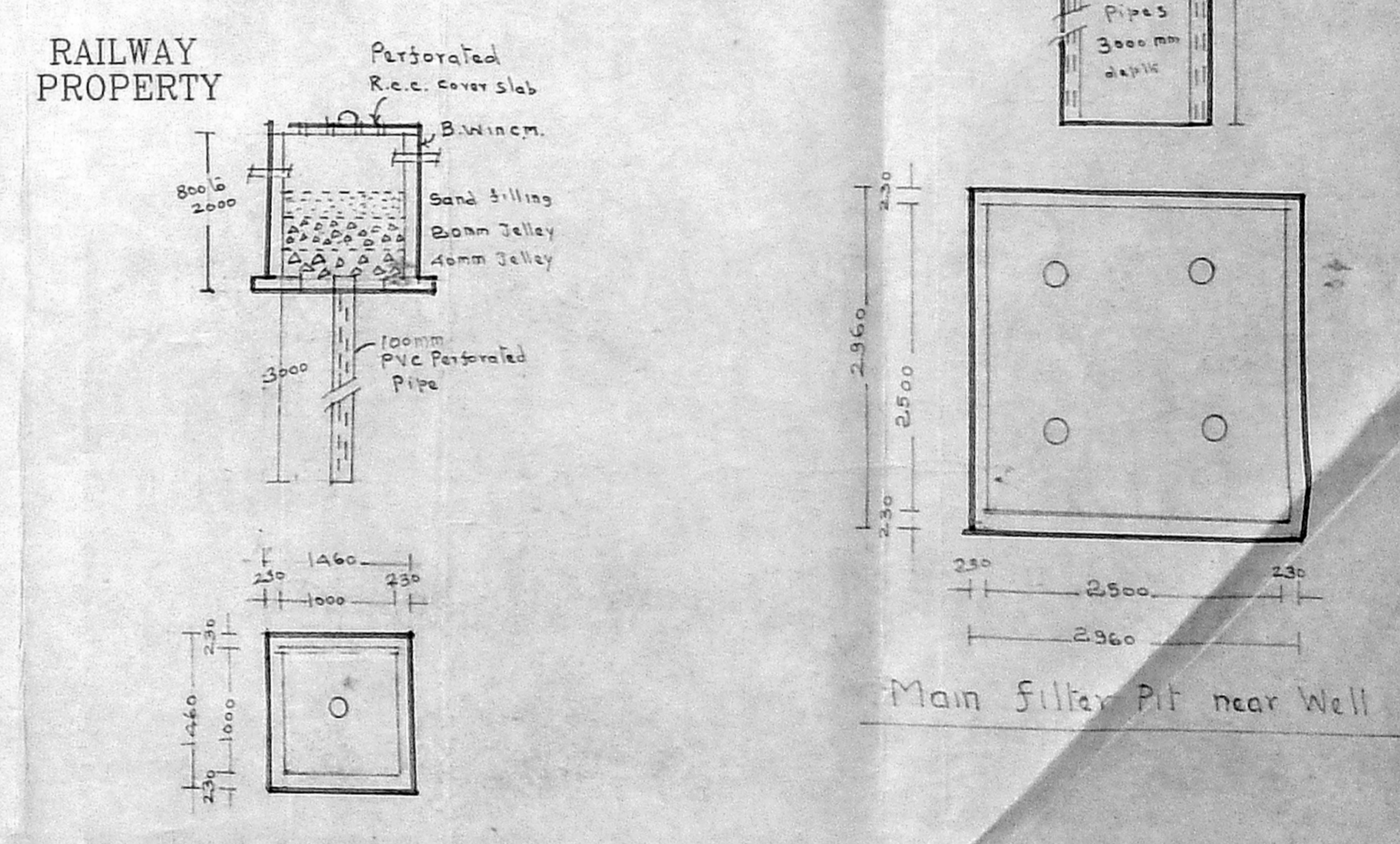
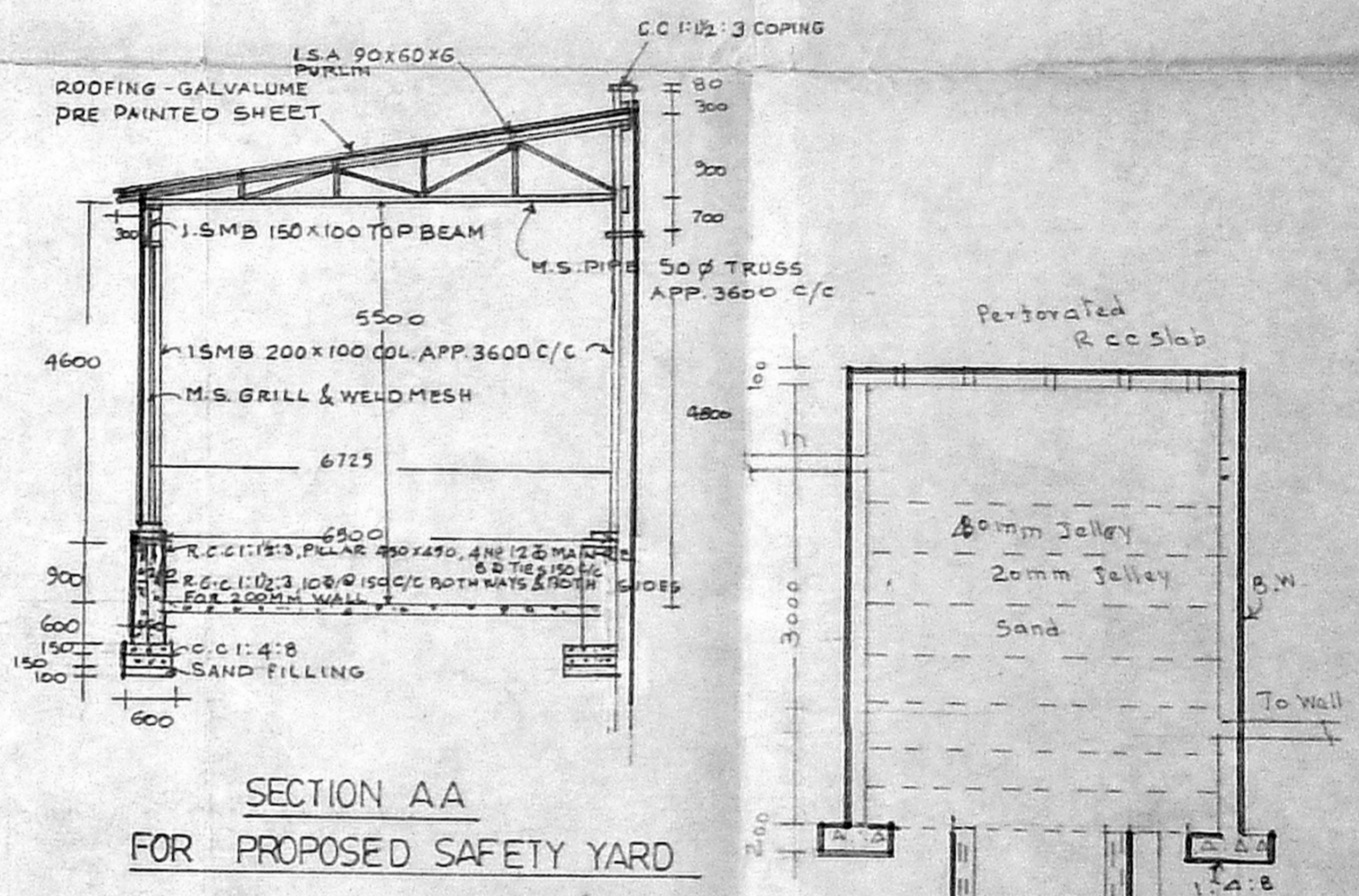
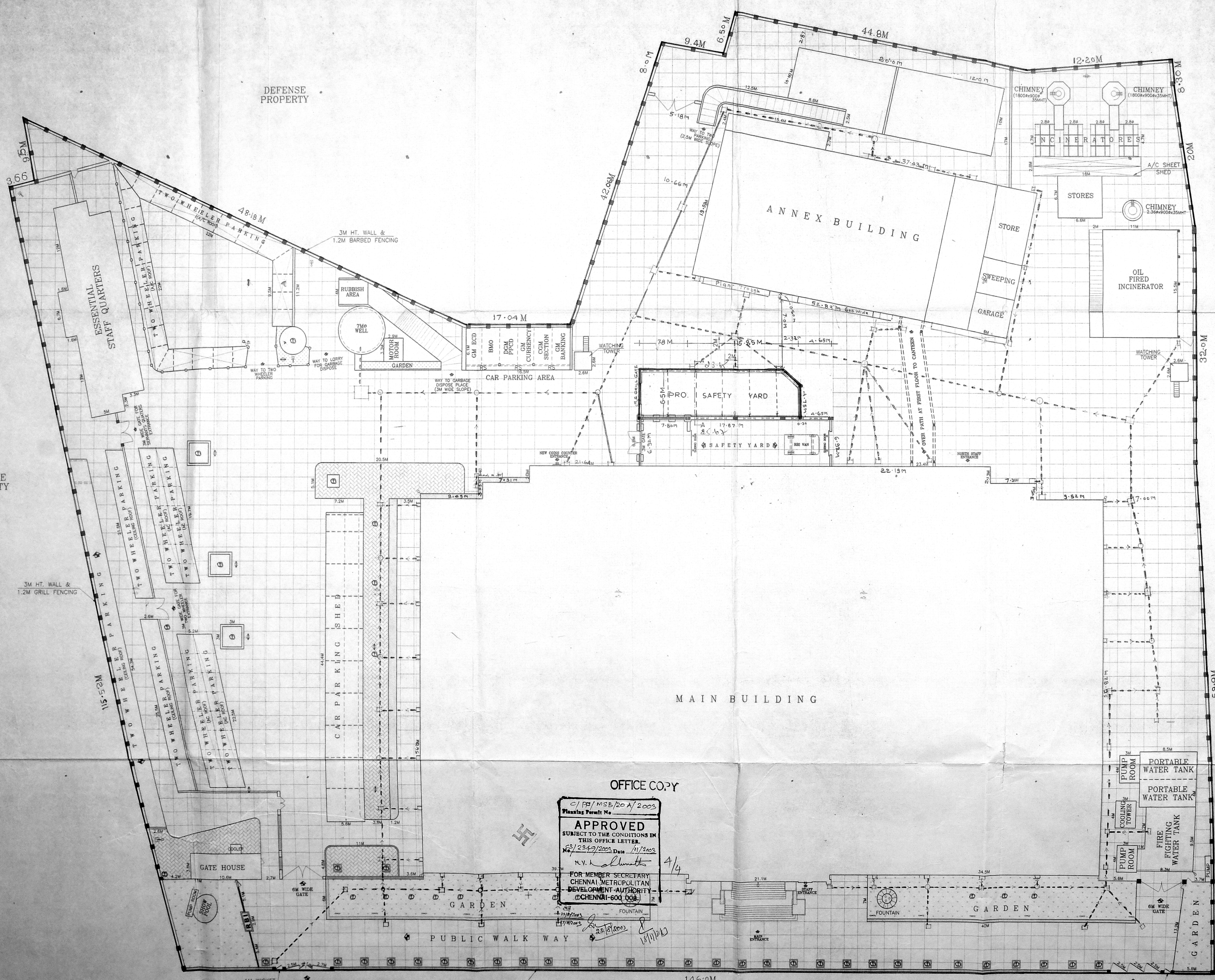

PROPOSED LAYOUT OF RAIN WATER HARVESTING PROJECT AND PROPOSED SAFETY YARD FOR CURRENCY CONTAINER AT MAIN OFFICE PREMISES, R.B.I. CHENNAI-600 001.

PREVIOUS PPA APPROVED BY M.M.D.A No CB/17149/99 Dt 20-7-99  
 PREVIOUS B.A APPROVED BY CORPN. No 251/99 Dt 17-9-99

| MARK | DESCRIPTION        | AREA IN M <sup>2</sup> | AREA IN FT <sup>2</sup> |
|------|--------------------|------------------------|-------------------------|
| 8    | GRAND TOTAL        | 22,499.0               |                         |
| 7    | TOTAL AREA         | 22,499.0               |                         |
| 6    | LIFT M/C ROOM ETC. | 441.35                 |                         |
| 5    | FOURTH FLOOR       | 1511.74                |                         |
| 4    | THIRD FLOOR        | 4326.95                |                         |
| 3    | SECOND FLOOR       | 4326.95                |                         |
| 2    | FIRST FLOOR        | 5622.40                |                         |
| 1    | GROUND FLOOR       | 6269.70                | 178-15                  |

| AREA LEGEND           |                | AREA IN M <sup>2</sup> | AREA IN FT <sup>2</sup> |
|-----------------------|----------------|------------------------|-------------------------|
| RESERVE BANK OF INDIA |                |                        |                         |
| RAJAJI SALAI          |                |                        |                         |
| CHENNAI - 600 001     |                |                        |                         |
| CHENNAI               |                |                        |                         |
| MASTER LAYOUT         |                |                        |                         |
| JOB NO.               | SCALE          | DRAWING NUMBER         | DATE                    |
| 1:225                 | PES-2000-00-35 |                        | 14.1.2003               |

OFFICE COPY  
 C/PP/MSB/20A/2003  
 Floating Permit No.  
**APPROVED**  
 SUBJECT TO THE CONDITIONS IN THIS OFFICE LETTER.  
 No 23/234/2003 Date 10/1/03  
 N.V. Kalimuthu  
 FOR MEMBER SECRETARY  
 CHENNAI METROPOLITAN  
 DEVELOPMENT AUTHORITY  
 (CHENNAI-600 008)

NOTES  
 ALL DIMENSIONS ARE IN MM UNLESS OTHERWISE SPECIFIED.

| COLOUR INDEX | DESCRIPTION   |
|--------------|---------------|
| [Line Style] | PROPOSED      |
| [Line Style] | EXISTING      |
| [Line Style] | ROAD BOUNDARY |

N. Nandakumar, AMISE,  
 Licensed Surveyor &  
 Consulting Engineer,  
 41, VIDYAGIRI STREET,  
 CHINTADRIPET, CHENNAI-500002,  
 Phone No. 2511162

R.B.I.  
 M.D.A.S.

CONNECTED DRAWINGS

TO RAJAJI SALAI

TO PARRYS